



### Glavno

Range of product	Harmony XVB Universal
Product or component type	Base unit
Component name	XVBC
Material	Glass reinforced polyamide base unit

### Komplementarno

Fixing mode	Direct or tube fixing
Mounting diameter	70 mm
Product destination	Banks without flash discharge tube unit
Electrical connection	1 connector for standard input
Cable entry	Bottom or side entry
Assembly style	Customer assembly, up to 5 units
Terminals description ISO n°1	(COM-1)PW (COM-2)PW (COM-3)PW (COM-4)PW (COM-5)PW (GND)GROUND
Product weight	0.16 kg

### Okolina

product certifications	CCC CSA C22-2 No 14 GOST UL 508
standards	EN/IEC 60947-5-1
protective treatment	TC
ambient air temperature for storage	-40...70 °C
NEMA degree of protection	NEMA 4X indoor UL 508

### Contractual warranty

Warranty period	18 months
-----------------	-----------

### Indicator Bank with “Flash” Discharge Tube Unit

#### Dimensions

Below drawing shows the minimum configuration of the product. Select the number of stages according to the product characteristics in order to get **b** dimension.

Informacije dane u ovoj dokumentaciji sadrže opće tehničke karakteristike o performansama ovdje sadržanih proizvoda.  
Ova dokumentacija nije namijenjena kao zamjena za niti bi se trebala koristiti za određivanje prikladnosti ili pouzdanosti predmetnih proizvoda za konkretne korisničke primjene.  
Svaki takav korisnik ili integrator dužan je provesti odgovarajuću i potpunu analizu rizika, procjenu i ispitivanje proizvoda u odnosu na odgovarajuću specifičnu primjenu ili uporabu istog.  
Niti društvo Schneider Electric Industries SAS niti bilo koje od njegovih povezanih poduzeća ili podružnica neće preuzeti obvezu ili snositi odgovornost za pogrešnu upotrebu ovdje sadržanih informacija.

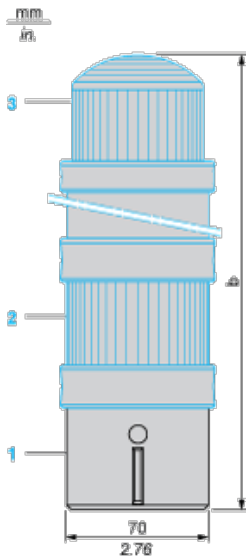

- (1) Base unit
- (2) Illuminated or audible signalling unit XVBC•••, to be ordered separately
- (3) "Flash" unit XVBC•••, to be ordered separately

Number of illuminated or audible signalling units other than "flash" tube	b in mm	b in in.
1	295	11.61
2	358	14.09
3	421	16.57
4	484	19.06

## Base Unit for Indicator Banks

### Panel Cut-out for Direct Fixing

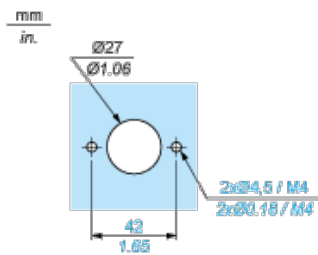

## Illuminated Beacon

### Wiring Diagram

