

XC1AC126

granična sklopka XC1AC – poluga s kotačićem – 1
NC + 1 NO – isklup prije uklopa



Glavno

| | |
|-------------------------------|---|
| Range of product | OsiSense XC |
| Series name | Special format |
| Product or component type | Limit switch |
| Product specific application | Materials handling |
| Device short name | XC1AC |
| Sensor design | - |
| Body type | Fixed |
| Head type | Plunger head |
| Material | Metal |
| Fixing mode | By the body |
| Movement of operating head | Linear |
| Type of operator | Spring return roller lever metal - |
| Switch actuation | By 30° cam |
| Type of approach | Lateral approach 2 directions |
| Electrical connection | Screw-clamp terminals, 1 x 0.5...1 x 2.5 mm ² |
| Cable entry | 3 entries tapped for Pg 13.5 cable gland, cable outer diameter: 9...12 mm |
| Number of poles | 2 |
| Contacts type and composition | 1 NC + 1 NO |
| Contact operation | Slow-break, break before make |
| Number of steps | 1 |
| Positive opening | Without |
| Minimum force for tripping | 23 N |

Komplementarno

| | |
|--|---|
| Contacts insulation form | Zb |
| Maximum actuation speed | 1 m/s from left 0.5 m/s from right |
| [Ithe] conventional enclosed thermal current | 10 A |
| [Ui] rated insulation voltage | 500 V AC IEC 60947-5-1 500 V AC NF C 20-040 600 V DC IEC 60947-5-1 600 V DC NF C 20-040 600 V AC CSA C22.2 No 14 600 V DC CSA C22.2 No 14 |
| Resistance across terminals | <= 8 mOhm |
| Short-circuit protection | 10 A cartridge fuse gG |
| Electrical durability | 1000000 cycles AC-15, 110 V 900 VA, <= 60 cyc/mn, load factor: 0.5 conforming to IEC 60947-5-1 appendix C 50/60 Hz, inductive load type 1000000 cycles AC-15, 230 V 1900 VA, <= 60 cyc/mn, load factor: 0.5 conforming to IEC 60947-5-1 appendix C 50/60 Hz, inductive load type 1000000 cycles AC-15, 48 V 450 VA, <= 60 cyc/mn, load factor: 0.5 conforming to IEC 60947-5-1 appendix C 50/60 Hz, inductive load type 1000000 cycles DC-13, 110 V 100 W, <= 60 cyc/mn, load factor: 0.5 conforming to IEC 60947-5-1 appendix C inductive load type 1000000 cycles DC-13, 230 V 95 W, <= 60 cyc/mn, load factor: 0.5 conforming to IEC 60947-5-1 appendix C inductive load type 1000000 cycles DC-13, 48 V 100 W, <= 60 cyc/mn, load factor: 0.5 conforming to IEC 60947-5-1 appendix C inductive load type 3000000 cycles AC-15, 110 V 350 VA, <= 60 cyc/mn, load factor: 0.5 conforming to |

Informacije dane u ovoj dokumentaciji sadrže opće i/ili tehničke karakteristike o performansama ovdje sadržanih proizvoda. Ova dokumentacija nije namijenjena kao zamjena za niti bi se trebala koristiti za određivanje prikladnosti ili pouzdanosti predmetnih proizvoda za konkretne korisničke primjene. Svaki takav korisnik ili integrator dužan je provesti odgovarajuću i poplunu analizu rizika, procjenu i ispitivanje proizvoda u odnosu na odgovarajuću specifičnu primjenu ili uporabu istog. Niti društvo Schneider Electric Industries SAS niti bilo koje od njegovih povezanih poduzeća ili podružnica neće preuzeti obvezu ili snositi odgovornost za pogrešnu upotrebu ovdje sadržanih informacija.

IEC 60947-5-1 appendix C 50/60 Hz, inductive load type
 3000000 cycles AC-15, 230 V 430 VA, <= 60 cyc/mn, load factor: 0.5 conforming to IEC 60947-5-1 appendix C 50/60 Hz, inductive load type
 3000000 cycles AC-15, 48 V 170 VA, <= 60 cyc/mn, load factor: 0.5 conforming to IEC 60947-5-1 appendix C 50/60 Hz, inductive load type
 3000000 cycles DC-13, 110 V 40 W, <= 60 cyc/mn, load factor: 0.5 conforming to IEC 60947-5-1 appendix C inductive load type
 3000000 cycles DC-13, 230 V 33 W, <= 60 cyc/mn, load factor: 0.5 conforming to IEC 60947-5-1 appendix C inductive load type
 3000000 cycles DC-13, 48 V 35 W, <= 60 cyc/mn, load factor: 0.5 conforming to IEC 60947-5-1 appendix C inductive load type

| | |
|-------------------------------|------------------------|
| Mechanical durability | 10000000 cycles |
| Width | 77 mm |
| Height | 157 mm |
| Depth | 44 mm |
| Product weight | 0.87 kg |
| Terminals description ISO n°1 | (11-12)NC (13-14)NO |

Okolina

| | |
|---------------------------------------|---|
| shock resistance | 95 gn 11 ms IEC 60068-2-27 |
| vibration resistance | 9 gn 10...500 Hz IEC 60068-2-6 |
| IP degree of protection | IP65 IEC 60529 IP65 NF C 20-010 |
| electrical shock protection class | Class I conforming to IEC 61140 Class I conforming to NF C 20-030 |
| ambient air temperature for operation | -25...70 °C |
| ambient air temperature for storage | -40...70 °C |
| protective treatment | TC |
| operating position | Any position |
| product certifications | CSA |
| standards | EN 60947-5-1 IEC 60337-1 IEC 60947-5-1 VDE 0660-200 CSA C22.2 No 14 |

Offer Sustainability

| | |
|---|---|
| Green Premium product | Green Premium product |
| Compliant - since 1150 - Schneider Electric declaration of conformity | Compliant - since 1150 - Schneider Electric declaration of conformity |
| Reference not containing SVHC above the threshold | Reference not containing SVHC above the threshold |
| Need no specific recycling operations | Need no specific recycling operations |

Contractual warranty

| | |
|-----------------|-----------|
| Warranty period | 18 months |
|-----------------|-----------|

Dimensions

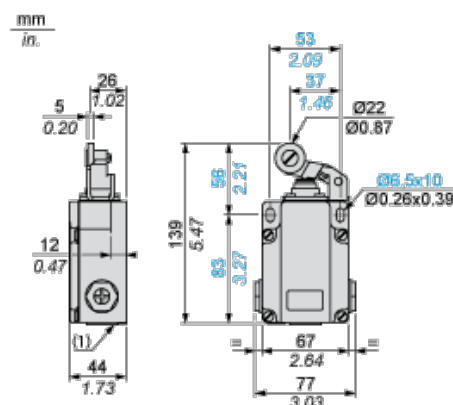

(1) 3 tapped entries for Pg 13.5 cable gland

Adaptator Dimensions for ISO M20 x 1.5

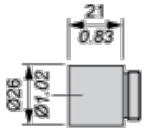

Wiring Diagram

2-pole NC + NO Break Before Make, Slow Break

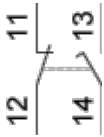

Characteristics of Actuation

Switch Actuation by 30° Cam

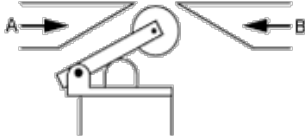

Functionnal Diagram

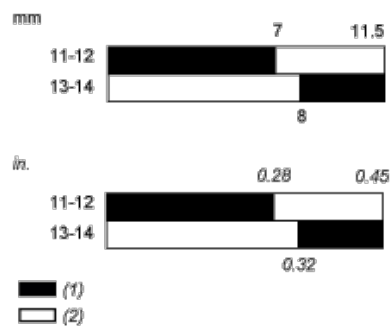

(1) Closed

(2) Open